

Fish tapes
Cable pulling device system



Fish tapes

Perlon fish tapes

made from stretched „Bayer-Perlon wire“, black, with solid steel end pieces, with additional pilot spring, approx. 120 mm length



Art. no.	TL	Ø	kg/100	PU	PE
150220	5	3	6,000	1	1
150222	10	3	10,300	1	1
150224	15	3	14,100	1	1
150226	20	3	18,800	1	1
150228	25	3	24,600	1	1
150230	30	3	24,400	1	1
150241	10	4	16,000	1	1
150243	15	4	23,400	1	1
150245	20	4	30,300	1	1
150247	25	4	38,600	1	1

Perlon fish tapes

made from stretched „Bayer-Perlon wire“, black, with solid steel end pieces, without additional pilot spring, strip size 4 mm



Art. no.	TL	Ø	kg/100	PU	PE
150232	10	4	15,200	1	1
150234	15	4	23,600	1	1
150236	20	4	30,300	1	1
150238	25	4	40,200	1	1
150239	30	4	44,500	1	1

Perlon fish tapes

made from stretched „Bayer-Perlon wire“, black, with solid steel end pieces, with 2 eyes, strip size 3 mm



Art. no.	TL	Ø	kg/100	PU	PE
150450	5	3	4,800	1	1
150452	10	3	9,900	1	1
150454	15	3	13,900	1	1
150456	20	3	16,300	1	1
150458	25	3	21,800	1	1
150462	5	4	8,000	1	1
150464	10	4	15,800	1	1
150466	15	4	24,000	1	1
150468	20	4	29,200	1	1
150470	25	4	38,900	1	1

Perlon fish tapes

made from stretched „Bayer-Perlon wire“, black, with solid steel end pieces, with 2 spring and 2 eyes, strip size 4 mm

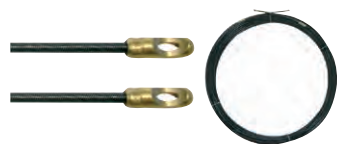

Art. no.	TL	Ø	kg/100	PU	PE
150476	10	4	18,000	1	1
150478	15	4	26,000	1	1
150480	20	4	33,200	1	1
150482	25	4	41,200	1	1

Steel fish tapes

with eyelet and brass rolling ball, without additional pilot spring

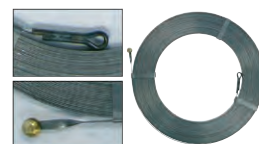

Art. no.	TL	Ø	kg/100	PU	PE
150152	10	3,5	13,100	1	1
150154	15	3,5	20,800	1	1
150156	20	3,5	26,800	1	1
150158	25	3,5	32,300	1	1

Spiral fish tapes

made from steel spirals, fourfold twisted, with solid steel end pieces, strip size 4 mm



Art. no.	TL	Ø	kg/100	PU	PE
150200	5	4	31,200	1	1
150202	10	4	69,100	1	1
150204	15	4	98,800	1	1
150206	20	4	134,300	1	1
150208	25	4	182,000	1	1
150210	30	4	185,900	1	1

Fibreglas section fish rods kits

Fibre glass push rod set

in nylon bag.

Scope of delivery:

Push rod length: 7 m
5 rods 8 mm Ø black
2 rods 8 mm Ø white

Accessories:

1 hook, 1 chain, 1 magnet, 1 starting block, 1 pulling knob

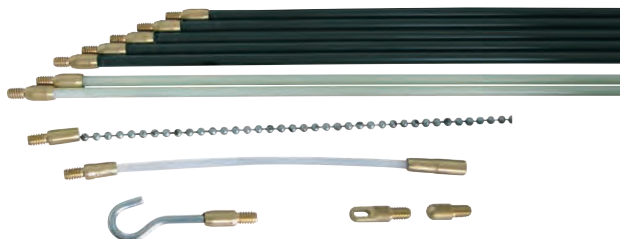

Art. no.	TL		kg	PU
150560	7	12 pcs.	0,500	1

Fibre glass push rod set

in nylon bag.

Scope of delivery:

Push rod length: 10 m
2 rods 6 mm Ø white
6 rods 5 mm Ø yellow
2 rods 4 mm Ø green

Accessories:

1 hook, 1 chain, 1 magnet, 1 starting block, 1 pulling knob, 1 LED lamp

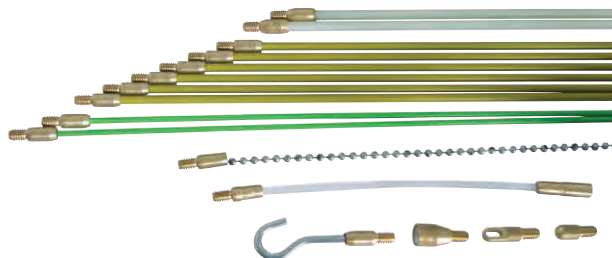

Art. no.	TL		kg	PU
150562	10	16 pcs.	0,700	1

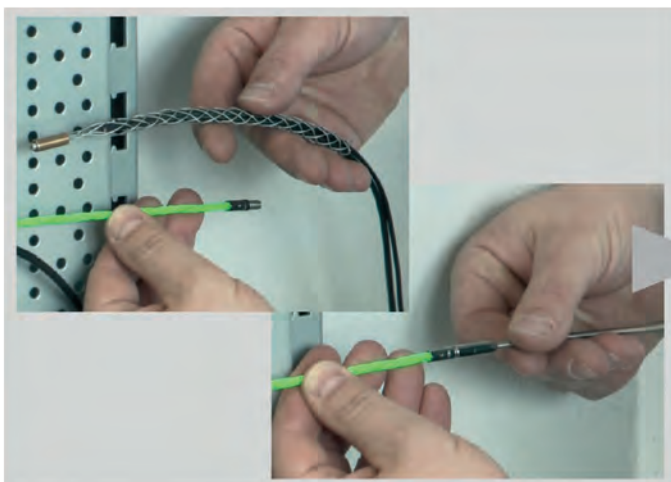

HAUPA PullTec

Cable pulling device HAUPA PullTec

with special plastic coating, M5 thread and probe, in durable plastic housing, colour: black
„Single Composite“, 4 mm green

The advantages of the HAUPA PullTec at a glance:

- Material: Coated with a special plastic
- Slides very well and is highly elastic
- Low friction • Does not break or bend
- M5 thread • With probe
- In durable plastic housing • Breaking load: 300 kg



Art. no.	TL	M5	Ø		kg	PU
143500	20	M5	4		1,300	1
143502	30	M5	4		1,500	1
143501	20	M5	4	replacement rod	1,000	1
143503	30	M5	4	replacement rod	1,200	1
143508		M5	6	guiding head	0,200	1

Cable pulling device HAUPA PullTec

with special plastic coating, M5 thread and probe, in durable plastic housing, colour: black
„Single Composite“, 5,2 mm black

The advantages of the HAUPA PullTec at a glance:

- Material: Coated with a special plastic
- Slides very well and is highly elastic
- Low friction • Does not break or bend
- M5 thread • With probe
- In durable plastic housing • Breaking load: 350 kg



Art. no.	TL	M5	Ø		kg	PU
143504	20	M5	5,2		1,500	1
143506	30	M5	5,2		1,700	1
143505	20	M5	5,2	replacement rod	1,100	1
143507	30	M5	5,2	replacement rod	1,300	1
143509		M5	6	guiding head	0,200	1

Additional accessories, see HAUPA fibre, page 88



naupa

...convincing solutions

Cable pulling device, accessories

Cable pulling device HAUPA-FIBRE

Cable pulling device with glass fibre rod \varnothing 3 mm, with PP casing, including front/end sleeve M5, 143010, 143024.

143000/143002 including:

- 143008 (2x)
- 143016 (2x)
- 143018 (2x)
- 143012
- 143014
- 143020
- 143026

143002/ECO including:

- 143008 (1x)



Art. no.	TL	\varnothing		kg	PU
143000	20	M5	3	HAUPA-FIBRE 20 m	1,199 1
143002	30	M5	3	HAUPA-FIBRE 30 m	1,500 1
143002/ECO	30	M5	3	HAUPA-FIBRE 30 m	1,198 1

Pulling unit with loop M5



Art. no.	\varnothing	kg	PU
143008	M5 6	0,020	1

Guiding head with loop M5



Art. no.	\varnothing	kg	PU
143010	M5 6	0,200	1

Guiding head M5



Art. no.	\varnothing	kg	PU
143012	M5 7	0,010	1

Guiding head M5



Art. no.	\varnothing	kg	PU
143014	M5 10	0,011	1

Guiding head \varnothing 13 mm M5



Art. no.	\varnothing	kg	PU
143030	M5 13	0,017	1

Front/end sleeve M5



Art. no.	kg	PU
143016	M5 0,005	1

Connection sleeve for probes \varnothing 3 mm



Art. no.	\varnothing	kg	PU
143018	M5 3	0,003	1

Cable grips



Art. no.	TL	\varnothing	kg	PU
143020	200	M5 4-6	0,007	1

Special pulling aid

for fast pulling of glass fibre rods \varnothing 3 mm



Art. no.	\varnothing	kg	PU
143024	3 - 6	0,047	1

Special fast glue for glass fibre rod \varnothing 3 mm



Art. no.	kg	PU
143026	0,012	1

Replacement glass fibre rod

\varnothing 3 mm, length 20/30 m, including front/end sleeve M5



Art. no.	TL	\varnothing	kg	PU
143004	20	3	0,022	1
143006	30	3	0,034	1

Service set for HAUPA-FIBRE

5 front sleeves, 5 guiding heads, 3 connection sleeves, 1 special fast glue



Art. no.	kg	PU
143028	M5 0,041	1

Cable pulling device, accessories

Cable pulling device FOX

Cable pulling device FOX with glass fibre rod \varnothing 4.5 mm and green PP coating RAL 6018, with zinc steel winder \varnothing 330 mm, standing version, complete with front/end sleeve M5 and pulling head M5 with loop



Art. no.	TL		\varnothing	kg	PU
143050	40	M5	4,5	3,900	1
143052	60	M5	4,5	4,400	1
143054	80	M5	4,5	4,800	1

Replacement glass fibre rod FOX

\varnothing 4.5 mm, complete with front/end sleeve M5



Art. no.	TL		\varnothing	kg	PU
143056	40	M5	4,5	0,900	1
143058	60	M5	4,5	1,400	1
143060	80	M5	4,5	1,800	1

Guiding head with loop M5



Art. no.		kg	PU
143062	M5	0,011	1

Front bulb with shackle M5



Art. no.		kg	PU
143064	M5	0,100	1

Guiding role made from aluminium M5



Art. no.		kg	PU
143066	M5	0,100	1

Guiding head M5



Art. no.		\varnothing	kg	PU
143012	M5	7	0,010	1
143014	M5	10	0,011	1
143030	M5	13	0,017	1

Guiding head set with heads \varnothing 7, 10, 13 mm M5



Art. no.			kg	PU
143068	M5	3-pieces	0,038	1

Front/end sleeve M5



Art. no.		kg	PU
143070	M5	0,100	1

Connection sleeve for probes \varnothing 4.5 mm



Art. no.	\varnothing	kg	PU
143072	4,5	0,002	1



haupa[®]

...convincing solutions

Germany: HAUPA, Koenigstr. 165-169, 42853 Remscheid, Phone: +49 (0)2191 8418-0, Fax: +49 (0)2191 8418-840, sales@haupa.com

Cable pulling device, accessories

Cable pulling device SIX

Cable pulling device SIX with glass fibre rod \varnothing 6.0 mm and green PP coating RAL 6018, with zinc steel winder \varnothing 550 mm, in lying and standing version with wheels, complete with front/end sleeve M6 and pulling head M6 with loop



lying version

Art. no.	TL	\varnothing	kg	PU
143100	40 M6	6	5,200	1
143102	60 M6	6	5,900	1
143104	80 M6	6	6,800	1
143105	100 M6	6	7,700	1

standing version

Art. no.	TL	\varnothing	kg	PU
143106	40 M6	6	7,200	1
143108	60 M6	6	8,300	1
143110	80 M6	6	9,400	1
143111	100 M6	6	10,300	1

standing version with wheels

Art. no.	TL	\varnothing	kg	PU
143112	40 M6	6	7,400	1
143114	60 M6	6	8,500	1
143116	80 M6	6	9,600	1
143117	100 M6	6	10,500	1

Replacement glass fibre rod SIX

\varnothing 6 mm, including front/end sleeve M5



Art. no.	TL	\varnothing	kg	PU
143118	40 M6	6	1,700	1
143120	60 M6	6	2,500	1
143122	80 M6	6	3,250	1
143124	100 M6	6	4,150	1

Guiding head with loop M6



Art. no.	\varnothing	kg	PU
143126	M6 6	0,018	1

Front bulb with shackle M6



Art. no.	\varnothing	kg	PU
143128	M6 6	0,022	1

Guiding role made from aluminium M6



Art. no.	\varnothing	kg	PU
143130	M6 6	0,026	1

Guiding head M6



Art. no.	\varnothing	kg	PU
143132	M6 6	0,017	1

Front/end sleeve M6



Art. no.	\varnothing	kg	PU
143134	M6 6	0,013	1

Connection shackle for probes \varnothing 6 mm



Art. no.	\varnothing	kg	PU
143136	6	0,012	1

Cable pulling device, accessories

Cable pulling device FIX

Cable pulling device FIX with glass fibre rod \varnothing 7.5 mm ad green PP coating RAL 6018, with zinc steel winder \varnothing 630 mm, in standing version and with wheels, including front/end sleeve M12 and front bulb with shackle M12



standing version

Art. no.	TL	\varnothing	kg	PU
143150	40 M12	7,5	8,100	1
143152	60 M12	7,5	9,400	1
143154	80 M12	7,5	10,700	1
143156	100 M12	7,5	11,900	1
143158	120 M12	7,5	13,100	1

standing version with wheels

Art. no.	TL	\varnothing	kg	PU
143160	40 M12	7,5	9,100	1
143162	60 M12	7,5	10,400	1
143164	80 M12	7,5	11,700	1
143166	100 M12	7,5	12,900	1
143168	120 M12	7,5	14,100	1

Replacement glass fibre rod FIX

\varnothing 7.5 mm, including front/end sleeve M12



Art. no.	TL	\varnothing	kg	PU
143170	40 M12	7,5	1,500	1
143172	60 M12	7,5	2,000	1
143174	80 M12	7,5	3,000	1
143176	100 M12	7,5	3,700	1
143178	120 M12	7,5	4,500	1

Front bulb with shackle M12



Art. no.	kg	PU
143180 M12	0,010	1

Guiding role made from aluminium M12



Art. no.	kg	PU
143182 M12	0,200	1

Guiding role made from aluminium, length 80 mm M12



Art. no.	\varnothing	kg	PU
143184 M12	40	0,220	1

Front/end sleeve M12



Art. no.	kg	PU
143186 M12	0,004	1

Connection sleeve for probes \varnothing 9 + 11 mm



Art. no.	\varnothing	kg	PU
143187	7,5	0,003	1

Connection sleeve with rotator



Art. no.	TL	\varnothing	kg	PU
143190	83 M12	30	0,006	1

Catch device made from zinc steel

Catch device made from zinc steel to connect glass fibre rods from two opposite sides with M12 connections on both sides



Art. no.	\varnothing	\varnothing St.	\varnothing tu/mm	kg	PU	
143192	M12	7,5	7,5	60-80	0,300	1

Catch device made from zinc steel

Catch device made from zinc steel to connect glass fibre rods from two opposite sides with M12 connections on both sides



Art. no.	\varnothing St.	\varnothing tu/mm	kg	PU
143194	M12 7,5/9/11/14,5	80-100	0,350	1
143196	M12 7,5/9/11/14,5	100-125	0,046	1
143198	M12 7,5/9/11/14,5	125-160	0,090	1

Pipe cleaning brush



Art. no.	\varnothing	kg	PU
143200	80 mm	0,200	1
143202	97 mm	0,098	1
143204	117 mm	0,400	1

haupa[®]

...convincing solutions

Germany: HAUPA, Koenigstr. 165-169, 42853 Remscheid, Phone: +49 (0)2191 8418-0, Fax: +49 (0)2191 8418-840, sales@haupa.com

Cable pulling device, accessories

Cable pulling device STRONG

Cable pulling device STRONG with glass fibre rod \varnothing 9 mm and green PP coating RAL 6018, with zinc steel winder \varnothing 795 mm (1000 with wheels), in standing version and with wheels, including front/end sleeve M12 and front bulbs with shackle M12



standing version

Art. no.	TL	\varnothing	kg	PU
143210	40 M12	9	9,100	1
143212	60 M12	9	12,900	1
143214	80 M12	9	14,820	1

standing version with wheels

Art. no.	TL	\varnothing	kg	PU
143216	100 M12	9	29,400	1
143218	120 M12	9	31,300	1
143220	150 M12	9	33,900	1

Replacement glass fibre rod STRONG

\varnothing 9 mm, including front/end sleeve M12

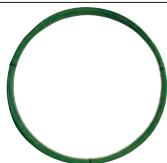

Art. no.	TL	\varnothing	kg	PU
143222	40 M12	9	3,800	1
143224	60 M12	9	5,500	1
143226	80 M12	9	7,500	1
143228	100 M12	9	9,400	1
143230	120 M12	9	11,300	1
143232	150 M12	9	13,900	1

Cable pulling device POWER

Cable pulling device POWER with glass fibre rod \varnothing 11 mm and green PP coating RAL 6018, with zinc steel winder \varnothing 1000 mm, width 150 mm, standing version with wheels, including front/end sleeve M12 and front bulb with shackle M12



standing version with wheels

Art. no.	TL	\varnothing	kg	PU
143250	150 M12	11	43,000	1
143252	200 M12	11	50,000	1
143254	250 M12	11	56,500	1
143256	300 M12	11	64,500	1

Replacement glass fibre rod POWER

\varnothing 9 mm, including front/end sleeve M12

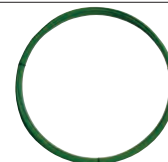

Art. no.	TL	\varnothing	kg	PU
143258	150 M12	11	21,900	1
143260	200 M12	11	29,200	1
143262	250 M12	11	36,400	1
143264	300 M12	11	43,900	1

Cable pulling device KING

Cable pulling device KING with glass fibre rod \varnothing 14.5 mm and black PP coating, with steel winder \varnothing 1500 mm with wheels, including front/end sleeve M12 and front bulb with shackle M12



standing version with wheels

Art. no.	TL	\varnothing	kg	PU
143270	150 M12	14,5	85,000	1
143272	200 M12	14,5	99,000	1
143274	250 M12	14,5	113,000	1
143276	300 M12	14,5	127,000	1
143278	350 M12	14,5	141,000	1
143280	400 M12	14,5	156,000	1

Cable pulling device, accessories

Front bulb with shackle M12



Art. no.		kg	PU
143180	M12	0,010	1

Guiding role made from aluminium M12



Art. no.		kg	PU
143182	M12	0,200	1

Guiding role made from aluminium, length 80 mm M12



Art. no.		∅	kg	PU
143184	M12	40	0,220	1

Front/end sleeve M12



Art. no.		kg	PU
143186	M12	0,004	1

Connection sleeve for probes



Art. no.		∅	kg	PU
143188		9	0,150	1
143266		11	0,075	1

Connection sleeve with rotator



Art. no.	TL	∅	kg	PU
143190	83 M12	30	0,006	1

Catch device made from zinced steel

Catch device made from zinced steel to connect glass fibre rods from two opposite sides with M12 connections on both sides



Art. no.	M12	∅ St.	∅tu/mm	kg	PU
143194		7,5/9/11/14,5	80-100	0,350	1
143196		7,5/9/11/14,5	100-125	0,046	1
143198		7,5/9/11/14,5	125-160	0,090	1

Pipe cleaning brush



Art. no.		∅	kg	PU
143200		80 mm	0,200	1
143202		97 mm	0,098	1
143204		117 mm	0,400	1



haupa[®]

...convincing solutions

Germany: HAUPA, Koenigstr. 165-169, 42853 Remscheid, Phone: +49 (0)2191 8418-0, Fax: +49 (0)2191 8418-840, sales@haupa.com

Accessories

Cable grips for electrical installations

Hand-braided cable grips made from zinc-plated steel braid with a flexible Towing ring with front unit M5 and integrally moulded Talurit ferrule



Art. no.	TL	M5	Ø	kg	PU
143300	200	M5	4-6	0,009	1
143302	210	M5	6-9	0,013	1
143304	350	M5	9-12	0,024	1
143306	350	M5	12-15	0,029	1
143308	500	M5	15-19	0,200	1
143310	500	M5	19-25	0,052	1
143312	450	M5	25-31	0,400	1

Cord und cable grips



Art. no.	TL	Ø	kg	PU
143336	2000	8-16	0,250	1
143338	2000	10-20	0,250	1
143340	2000	20-30	0,250	1
143342	2000	30-40	0,250	1

Cable grips for subterranean cable laying

Hand-braided cable grips made from zinc-plated steel braid with 1 loop or 2 loops and integrally moulded Talurit ferrule.

Cable stocking with 2 loops enables, both the pulling of cables and the tightening of cables by way of relocating the stocking on the pulled cable.

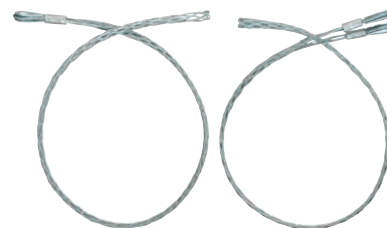

Art. no.	TL	Ø	Q	kg	PU
143314	1250	10-20	1	0,378	1
143318	1250	20-30	1	0,380	1
143322	1250	30-40	1	0,424	1
143326	1250	40-50	1	0,430	1
143330	1250	50-65	1	0,388	1
143334	1250	65-80	1	1,120	1
Art. no.	TL	Ø	Q	kg	PU
143316	1250	10-20	2	0,465	1
143320	1250	20-30	2	0,460	1
143324	1250	30-40	2	0,510	1
143328	1250	40-50	2	0,200	1
143332	1250	50-65	2	0,520	1

Legend cable pulling device

Rod diameter	Pipe diameter	Pushing energy	Min. bending radius	Breaking strength	Pulling strength with starting/ ending	Advised length	
Ø mm	Ø mm	kg	mm	kg	kg	m	page
FIBRE 3,0 mm	16-32	+++	160	400	110	20-30 (+ 2-3 m)	88
PullTec 4,0 mm	16-32	+++	100	300	130	10-30 (+ 3-5 m)	87
PullTec 5,2 mm	20-32	+++	100	350	140	10-40 (+ 3-5 m)	87
FOX 4,5 mm	40-60	+++	310	1200	170	20-40 (+ 3-5 m)	89
SIX 6,0 mm	50-80	++++	400	2000	230	30-60 (+ 3-5 m)	90
FIX 7,5 mm	63-100	++++	500	3200	290	40-70 (+ 3-5 m)	91
STRONG 9,0 mm	63-125	++++	620	4400	340	60-150 (+ 3-5 m)	92
POWER 11,0 mm	63-150	++++	770	6250	500	100-300 (+ 3-5 m)	92
KING 15,0 mm	100-250	++++	1150	15000	550	150-450 (+ 3-5 m)	92
PERLON® 3,0 mm	16	+	80	200	110	5-15 (+ 2-3 m)	86
SPIRAL 4,0 mm	20-32	+	180	115	115	10-25 (+ 3-5 m)	86